

**STRAIGHT FEMALE PLUG CRIMP TYPE**

**R114.082.375**

**CABLE 2.6/50 S**

Series : SMB CARLOCK

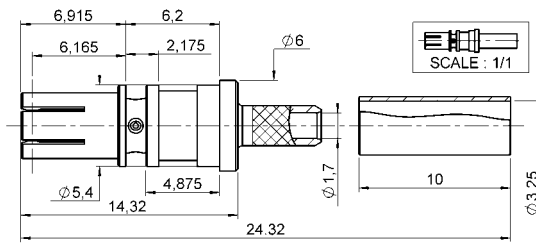

Stamped and formed center contact to be ordered and delivered separately P/N 250.01.352

- Tape & reel packaging : by 10000
- Diameter of the reel: 600 mm
- Pitch between contacts: 5 mm
- Plating for contact area :Gold 0.5 over Nickel2
- Plating for crimp area :Tin 1 over Nickel 2

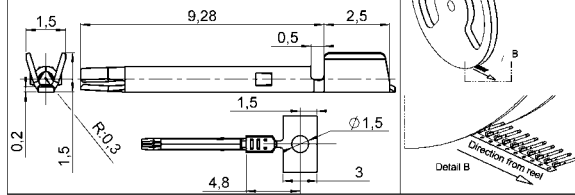

All dimensions are in mm.



COMPONENTS	MATERIALS	PLATINGS (µm)
<b>BODY</b>	<b>BRONZE</b>	<b>NICKEL 2</b>
<b>CENTER CONTACT</b>	<b>BRONZE</b>	<b>SELECTIVE GOLD+ SELECTIVE TIN</b>
<b>OUTER CONTACT</b>	-	-
<b>INSULATOR</b>	<b>TPX</b>	
<b>GASKET</b>	-	
<b>OTHERS PARTS</b>	<b>BRASS</b>	<b>NICKEL 2</b>
-	-	-
-	-	-

Issue : 0622 A

In the effort to improve our products, we reserve the right to make changes judged to be necessary.



**STRAIGHT FEMALE PLUG CRIMP TYPE**

**R114.082.375**

**CABLE 2.6/50 S**

Series : **SMB CARLOCK**

**PACKAGING**

Standard	Unit	Other
<b>100</b>	<b>'W' option</b>	<b>Contact us</b>

**SPECIFICATION**

**ELECTRICAL CHARACTERISTICS**

Impedance		<b>50</b> Ω
Frequency		<b>0-4</b> GHz
VSWR	<b>1.25 +</b>	<b>0,0000</b> x F(GHz) Maxi
Insertion loss		<b>0.25</b> √F(GHz) dB Maxi
RF leakage	- (	<b>NA</b> - F(GHz)) dB Maxi
Voltage rating		<b>335</b> Veff Maxi
Dielectric withstanding voltage		<b>1000</b> Veff mini
Insulation resistance		<b>1000</b> MΩ mini

**CABLE ASSEMBLY**

Stripping	a	b	c	d	e	f
mm	3,00	5,50	10,0	0,00	7,00	0,00

Assembly instruction : **See Page3&4**

Recommended cable(s)  
RG 174  
RG 316

Characteristics indicated on this data sheet are those that can be achieved with the highest performance cable. Intrinsic limitations of the cable may diminish the performance of the assembly

Cable retention

- pull off	RG 316	<b>110</b> N mini
	RG 174	<b>65</b> N mini
- torque		<b>NA</b> N.cm

**MECHANICAL CHARACTERISTICS**

Center contact retention		
Axial force – Mating end	<b>10</b>	N mini
Axial force – Opposite end	<b>10</b>	N mini
Torque	<b>NA</b>	N.cm mini

**TOOLING**

Part Number	Description	Hexagon
.	.	.
<b>R282.271.000</b>	<b>CRIMPING TOOL</b>	<b>3.25</b>

Recommended torque		
Mating	<b>NA</b>	N.cm
Panel nut	<b>NA</b>	N.cm
Clamp nut	<b>NA</b>	N.cm
A/F clamp nut	<b>0,0000</b>	mm

Mating life	<b>25</b>	Cycles mini
Weight	<b>1,7500</b>	g

**OTHERS CHARACTERISTICS**

THIS COAX CAN BE USED WITH  
FAKRA2 PLUG HOUSING R197.112.\_90  
(replaced the\_ by the coding letter)

\* Depends on the cable used

**ENVIRONMENTAL**

Operating temperature	<b>-40/+90*</b>	° C
Hermetic seal	<b>NA</b>	Atm.cm3/s
Panel leakage	<b>NA</b>	

Issue : **0622 A**

In the effort to improve our products, we reserve the right to make changes judged to be necessary.



**STRAIGHT FEMALE PLUG CRIMP TYPE**

**R114.082.375**

**CABLE 2.6/50 S**

Series : SMB CARLOCK

**RECOMMENDED MOUNTING PROCEDURE**

1

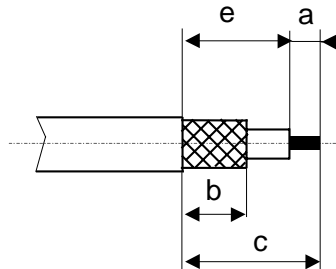

• Strip the cable

2

• Crimp the centre contact with crimping dies as described ,using standard mini applicator .

• check the crimping height  $B=0.80 \pm 0.03$  and the crimping width  $A=1 \pm 0.05$  of the center contact.

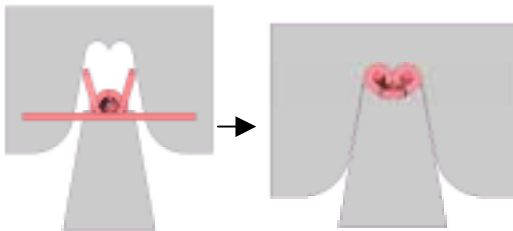

Dielectric of the cable must be as close as possible from the centre contact, not more than 0.5 mm

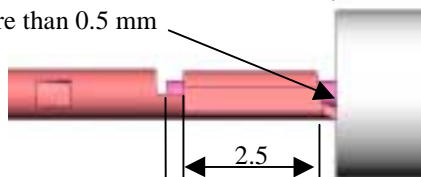

0.25 Max position of the inner conductor of the cable

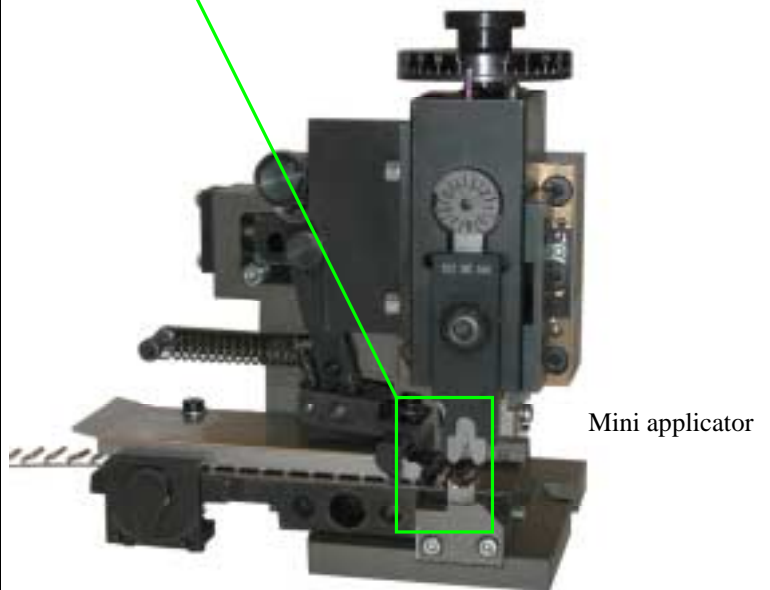
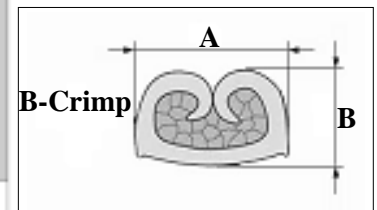
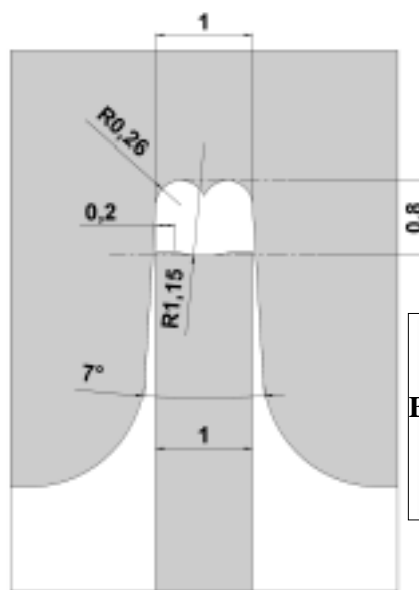
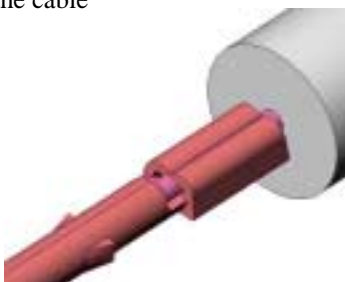

Mini applicator

Issue : 0622 A

In the effort to improve our products, we reserve the right to make changes judged to be necessary.





**STRAIGHT FEMALE PLUG CRIMP TYPE**

**R114.082.375**

**CABLE 2.6/50 S**

Series : SMB CARLOCK

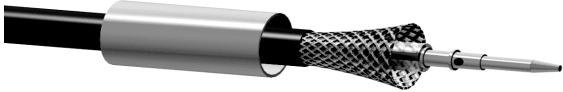
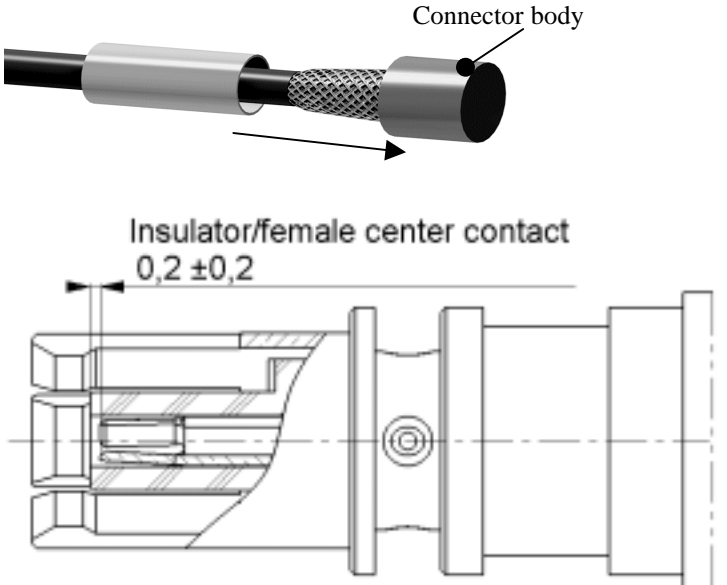
**RECOMMENDED MOUNTING PROCEDURE**

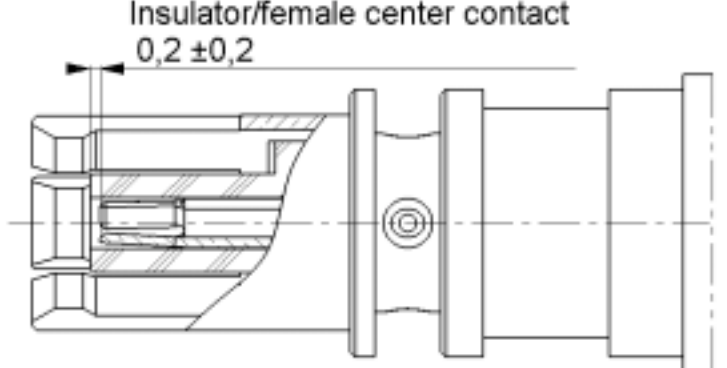
<p><b>3</b></p> <ul style="list-style-type: none"> <li>• Slide the ferrule</li> <li>• Fan the braid</li> </ul>	
<p><b>4</b></p> <ul style="list-style-type: none"> <li>• Slide the cable into the connector body until the center contact reach the dimension <math>0.2 \pm 0.2</math></li> </ul>	 <p>Connector body</p> <p>Insulator/female center contact <math>0,2 \pm 0,2</math></p>
<p><b>5</b></p> <ul style="list-style-type: none"> <li>• Slide the ferrule over the braid</li> <li>• Crimp the ferrule with crimping tool R282.271.000 (Hex:3.25) or crimping tool R282.293.000 (M22520/5-01) + dies R282.235.003 (M22520/5-03)</li> </ul>	
<p><b>6</b></p> <ul style="list-style-type: none"> <li>• Check the position of the center contact between the top of the insulator and the top of the center contact : <math>0.2 \pm 0.2</math></li> </ul>	 <p>Insulator/female center contact <math>0,2 \pm 0,2</math></p>

Issue : 0622 A

In the effort to improve our products, we reserve the right to make changes judged to be necessary.

